

REV.	ECN.NO	APPD
A0	/	/

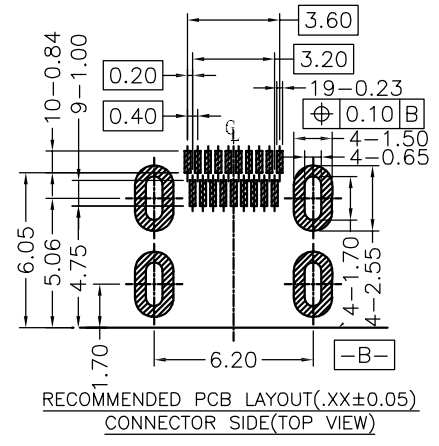

- NOTES:
- MATERIAL:
 - Housing: thermoplastic plastics
 - terminals: Copper Alloy
Gold plated in contact area;
Tin plated in termination
Nickel Plated overall
 - Shell: Steel&Copper Alloy
Nickel/Au Plated overall
 - ELECTRICAL CHARACTERISTICS:
 - Rating Current :0.5 Ampere
 - Rating Voltage :40 V Max
 - Contact Resistance:30 Milli ohms
 - Insulation Resistance:100 Mega ohms Min.
 - MECHANICAL CHARACTERISTICS:
 - Connector Mating force: 4.5kg MAX
 - Connector Unmating force:1.0Kg min
 - Durability:10000Cycles.
 - ENVIRONMENT CHARACTERISTICS:
 - Operating temperature:-20℃ to +85℃
 - Storage temperature:-20℃ to +65℃

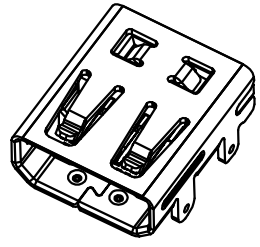
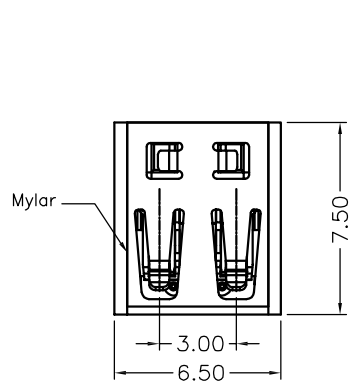
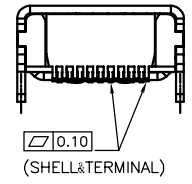
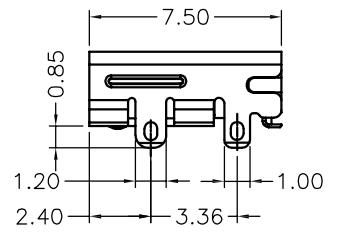
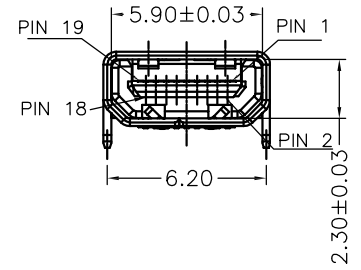

HD22-3515-G61038

5:铜壳镀镍
3:载带
1:黑色
6:LCP
G:半金G/Fu"

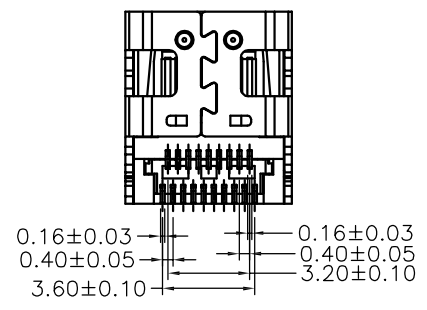

TOLERANCE UNLESS OTHERWISE SPECIFIED		FLW 深圳市华联威电子科技有限公司					
.XXX ±0.10		HUA LIAN WEI TECHNOLOGY ELECTRONICS CO;LTD.					
.XX ±0.20		.X* ±3*					
.X ±0.30		.XX* ±2*					
APPROVED		PART NAME:	MICRO HDMI 固定脚全插				
CHECKED		PART No:	HD22-3515-G61038	C			
DRAWN	chenyiting	PROJECTION:	UNIT:	SCALE	SHEET	REV.	
DATE	2022.04.14		mm	1:1	10F1	A0	