

REV.	ECN.NO.	APPD.
A	/	ZFY

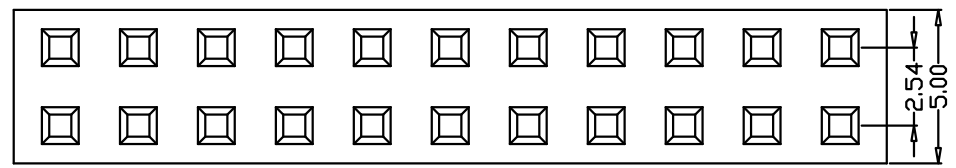

- 技术指标 (Technical Index) :
1. 工作温度 (Temperature range) : -25° C-85° C.
  2. 额定电压 (Rated voltage) : 250V DC/AC (rms)
  3. 额定电流 (Rated current) : 5A AC, DC
  4. 接触阻抗 (CONTACT Resistance) :  $\leq 25M\Omega$
  5. 耐压值 (Withstanding voltage) : 1500V AC/minute
  6. 绝缘阻抗 (Insulation resistance)  $\geq 1000M\Omega$

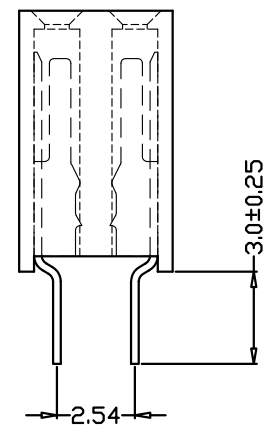
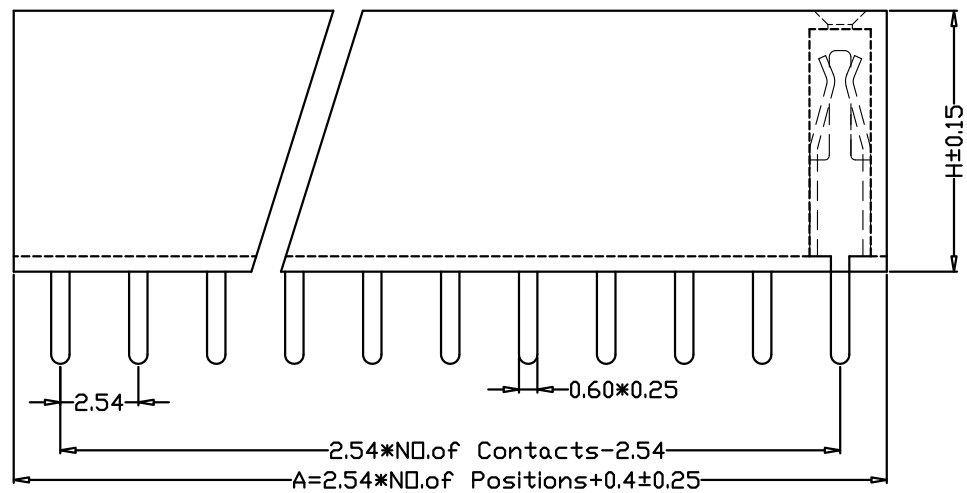

216104-1123-G31018

G: 镀半金G/Fu”

1: 盘装

1: 黑色

3: PA6T

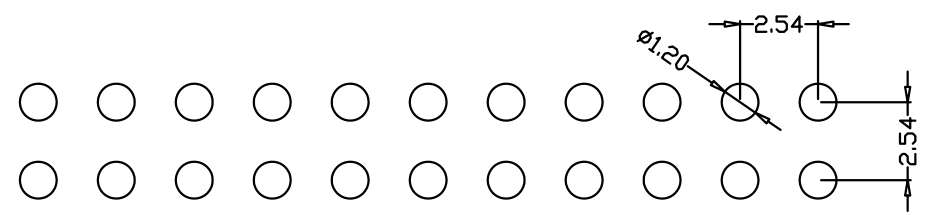

P. C. B LAYOUT

TOLERANCE UNLESS OTHERWISE SPECIFIED		<b>FLW</b> 深圳市华联威电子科技有限公司			
.XXX ±0.15	.XX ±0.20	.X ±0.30	HUA LIAN WEI TECHNOLOGY ELECTRONICS CO;LTD.		
		.X' ±5°			
		.XX' ±2°			
APPROVED		PART NAME:	2.54间距排母H7.1U型双排直插20PIN		
CHECKED		PART No:	216104-1123-G31018	C	
DRAWN	ZhangFenYan	PROJECTION:	UNIT:	SCALE	SHEET
DATE	2018.10.10		mm	1:1	10F1
					REV. A