

REV.	ECN. NO.	APPD.
A	EXXXXXXXXXX	chenyiting

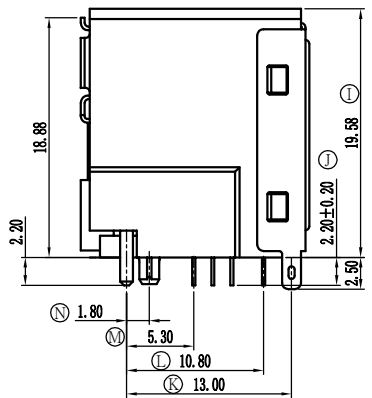
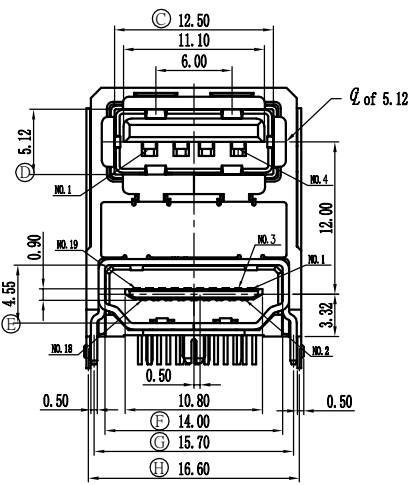
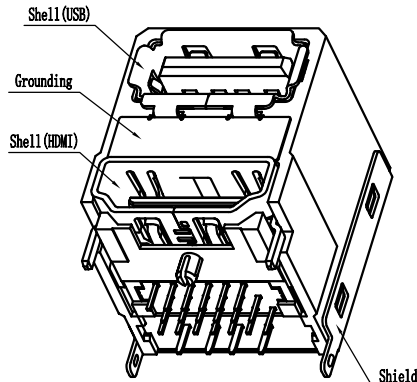
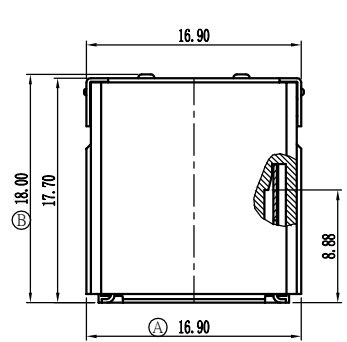

HDMI	Pin define
1	TMDS Data+
2	TMDS Data Shield
3	TMDS Data-
4	TMDS Data+
5	TMDS Data Shield
6	TMDS Data-
7	TMDS Data+
8	TMDS Data Shield
9	TMDS Data-
10	TMDS Clock+
11	TMDS Clock Shield
12	TMDS Clock-
13	CEC
14	Reserved (N.C. on device)
15	SCD
16	SDA
17	I2C/CEC Ground
18	+5V Power
19	Hot Plug Detect

USB 2.0	Pin define
1	VBUS
2	D-
3	D+
4	GND

- NOTES:
- MATERIAL:
 - Housing:thermoplastic plastics
 - terminals:Copper Alloy
Gold plated in contact area:
Tin plated in termination
Nickel Plated overall
 - Shell:Steel&Copper Alloy
Nickel/Au Plated overall
 - ELECTRICAL CHARACTERISTICS:
 - Rating Current :0.5 Ampere
 - Rating Voltage :40 V Max
 - Contact Resistance:30 Milli ohms
 - Insulation Resistance:100 Mega ohms Min.
 - MECHANICAL CHARACTERISTICS:
 - Connector Mating force: 4.5kg MAX
 - Connector Unmating force:1.0Kg min
 - Durability:10000Cycles.
 - ENVIRONMENT CHARACTERISTICS:
 - Operating temperature:-20℃ to +85℃
 - Storage temperature:-20℃ to +65℃

HD21-1611-G61018

- 1:铁壳镀镍
- G:半金G/Fu
- 6:LCP+PBT
- 1:吸塑盒
- 1:黑色

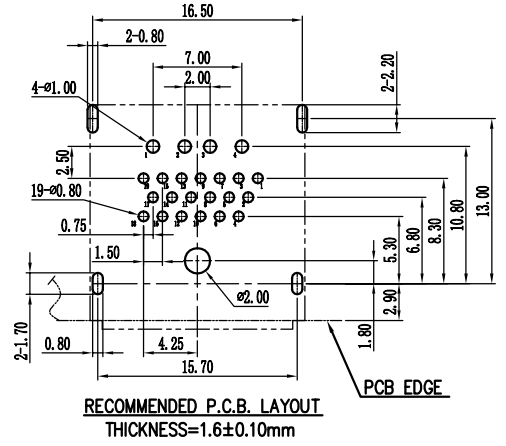
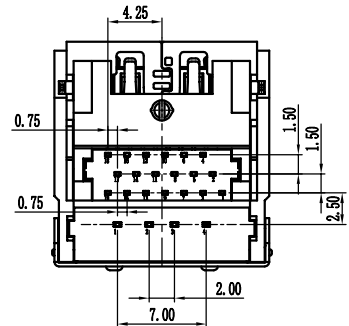

TOLERANCE UNLESS OTHERWISE SPECIFIED		FLW 深圳市华联威电子科技有限公司 HUA LIAN WEI TECHNOLOGY ELECTRONICS CO;LTD.				
.XXX ±0.10	.X° ±3°	APPROVED	PART NAME:	HDMI 19P+USB2.0 有定位柱		
.XX ±0.20	.XX° ±2°	CHECKED	PART No:	HD21-1611-G61018	C	
.X ±0.30		DRAWN	chenyiting	PROJECTION:	UNIT:	SCALE
		DATE	2023.04.04	mm	1:1	SHEET
					1 OF 1	REV.
						A