

REV.	ECH. NO.	APPD.
A	✓	ZFY

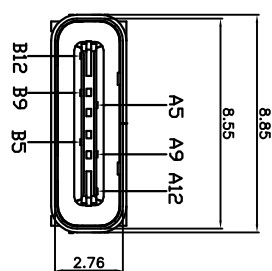

PIN	SIGNAL NAME
B12	GND
B9	VBUS
B5	CC2
A5	CC1
A9	VBUS
A12	GND

NOTES:

- MATERIAL:
 - MOLDING: LCP UL94 V-0
 - CONTACT: COPPER ALLOY.
 - GOLD PLATED Min ON CONTACT AREA, 100u"
 - Min TIN (LEAD FREE) ON SOLDER AREA,
 - SHELL: SUS201-H,T=0.30±0.03mm
 - 50u" NICKEL PLATING OVER ALL.
- MECHANICAL:
 - INSERTION: 5~20N.
 - EXTRACTION: 8~20N AFTER TEST.
 - DURABILITY: 5000 CYCLES
- ELECTRICAL:
 - CURRENT: 3A FOR VBUS;
 - 1.25A FOR GND PIN.
 - 0.25A FOR OTHER
- VOLTAGE: 20 V MAX
- WITHSTANDING VOLTAGE: 100V AC R.M.S.
- CONTACT RESISTANCE: 40mΩ MAX.
- INSULATION RESISTANCE: 100MΩ MIN.
4. ENVIRONMENTAL
 - TEMPERATURE RANGE -25°C ~ +85°C
- 尺寸标注事项:
 - 图示有标⊗者为首样全检, 重点管控尺寸.
 - 6. 产品符合ROHS标准

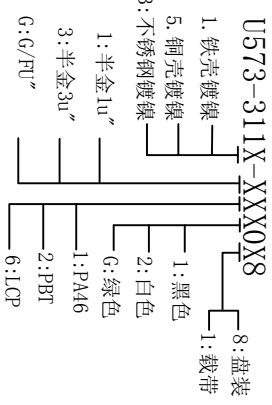
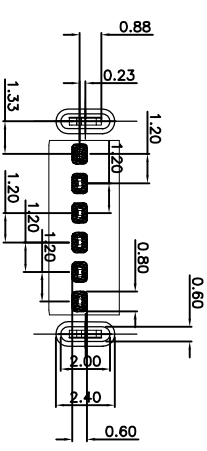
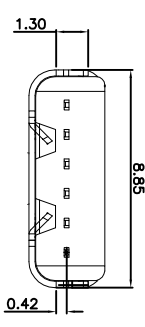
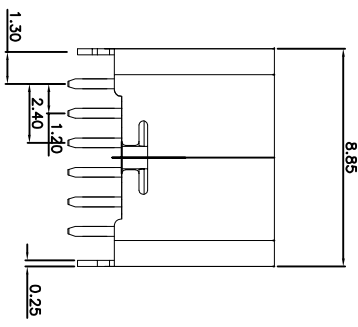
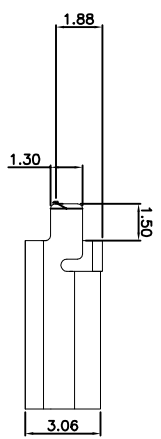
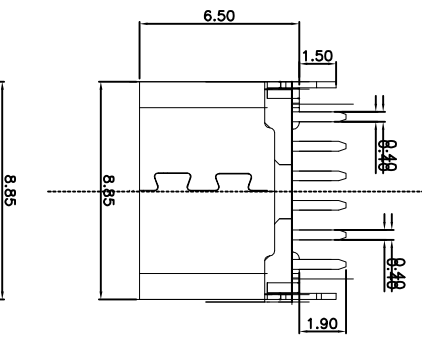

TOLERANCE UNLESS OTHERWISE SPECIFIED		深圳市华联威电子科技有限公司 HUA LIAN WEI TECHNOLOGY ELECTRONICS CO.,LTD.	
XXX ±0.15	XX ±0.20	X ±0.30	XX ±2
APPROVED	PART NAME:	TYPE C 6P 立插 6.5	
CHECKED	PART No:	U573-311X-XXXXX8	
DRAWN	PROJECTION:	UNIT:	SCALE
DATE	2018.10.10	mm	1:1
		SHEET	10F-1
		REV.	A

