

9

8

7

6

5

4

3

2

1

REV.	ECN.NO.	APPD.
A	/	/

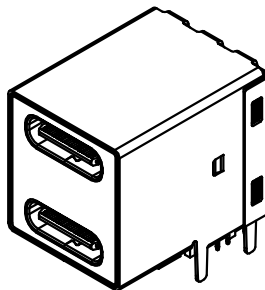
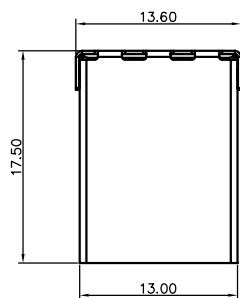

NOTES:

1.MATERIAL:

1.1 Housing:thermoplastic plastics

1.2 terminals:Copper Alloy

Gold plated in contact area:

Tin plated in termination

Nickel Plated overall

1.3 Shell:Steel&Copper Alloy

Nickel/Au Plated overall

2.characteristics:

2.1 Rating Voltage : 30V AC.

2.2 Rating Current:

5A for Vbus PIN;1.25A for Vconn PIN

2.3 Contact Resistance:40 mΩ MAX.

2.4 Insulation Resistance:100 MΩ MIN.

2.5 Withstanding Voltage:AC 100V

2.6 Mating force: 5~20N MAX

2.7 Extraction force:8~20N Min

2.8 Life test:10000Cycles MIN.

2.9 Temperature Range: -30℃~+80℃.

The product must be compliance ROHS

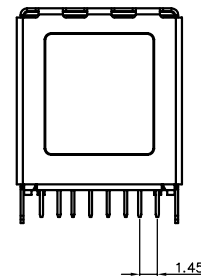
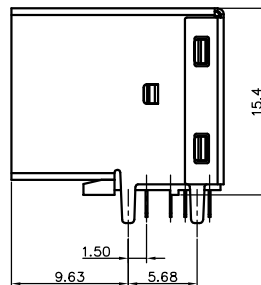
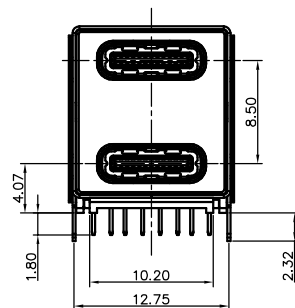

U573-181B-G61018

B:不锈钢镀镍

G:半金G/Fu

6:LCP

1:吸塑盒

1:黑色

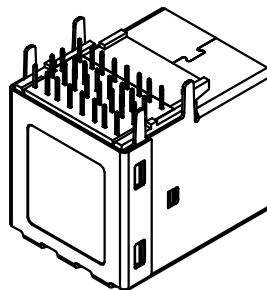
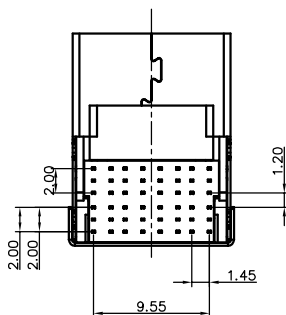

TOLERANCE UNLESS OTHERWISE SPECIFIED		FLW 深圳市华联威电子科技有限公司 HUA LIAN WEI TECHNOLOGY ELECTRONICS CO;LTD.			
.XXX ±0.10	.X' ±3'				
.XX ±0.20	.XX' ±2'				
.X ±0.30					

APPROVED		PART NAME:	TYPE C 双层16P 母座全包			
CHECKED		PART No:	U573-181B-G61018	C		
DRAWN	Qinyuhua	PROJECTION:	UNIT:	SCALE	SHEET	REV.
DATE	2021.11.06		mm	1:1	10F1	A

9

8

7

6

5

4

3

2

1